

IMPROVING PASSENGERS' MOBILITY, NEW IDEAS AND METHODS TO ENSURE SUSTAINABLE MOBILITY

STEP-UP | City of Šibenik, Department of economy,
entrepreneurship and development | Petar Mišura

STEP-UP Training Session | Trieste | 7th of May 2019

Five conditions to sustainable urban mobility

- ❑ Having a well-communicated and accepted vision on the development of the town
- ❑ Good governance
- ❑ Approving and supporting local initiatives
- ❑ Equal partners of technological companies
- ❑ Initiate, evaluate, terminate or implement experiments (pilots)

Master plan of sustainable urban mobility

- The basis for the implementation of projects in the field of transport



Key challenges in developing sustainable urban mobility

- ❑ Approximately 90 % of city residents do not use public bus transport
- ❑ Ship transport is characterized by poor port infrastructure and old ships (app. 40 years old)
- ❑ Lack of parking space due to special morphological structure of the city and narrow streets
- ❑ Opportunity – The development of intermodal point

Results of the survey about satisfaction of respondents in certain aspects of public transport service

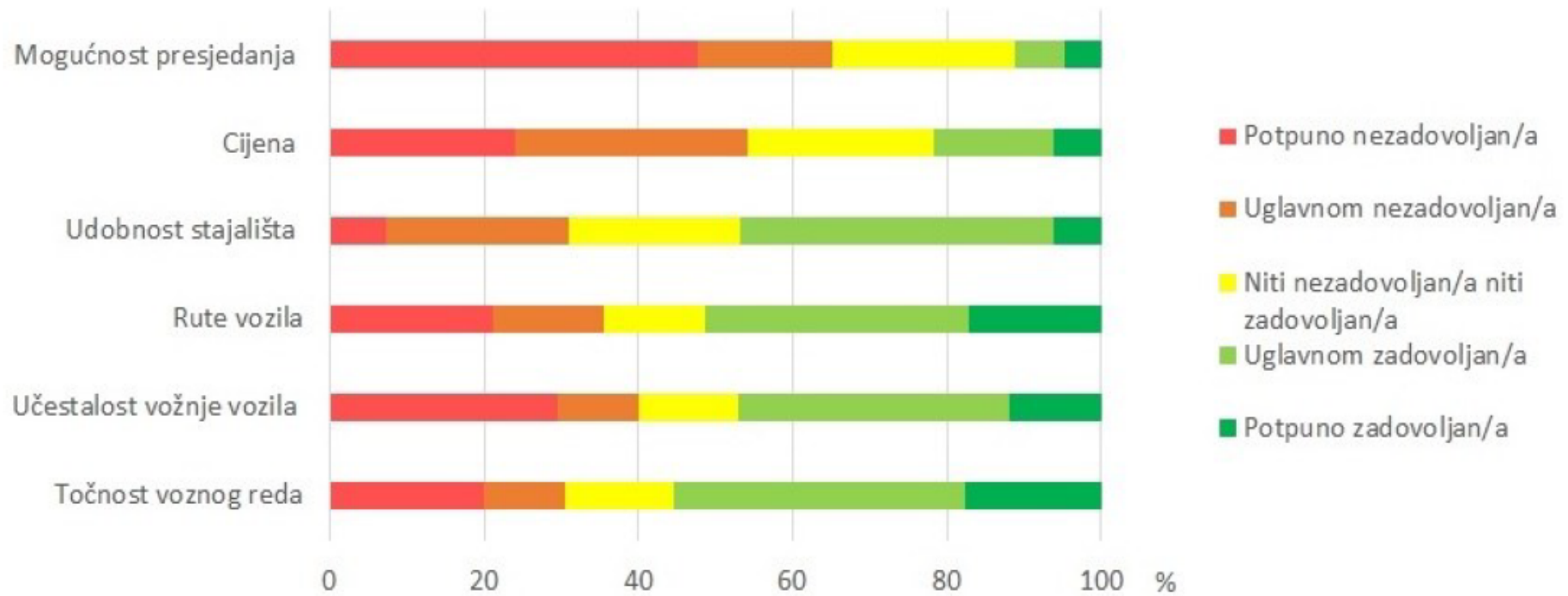

How can we improve passengers mobility?

- Project UrbEco
- Urban Escalator (project desing)
- Cable cars (project idea)
- Public parking garage
- Development of intermodal point
- Cross-border cooperation projects (STEP-UP, INTERMODAL, etc.)

UrbEco

- The goal: To establish intermodal bus and ship public transport based on innovative and ecological solutions



Urban escalator and cable cars

- ❑ Modern means of transport connecting cultural and historical monuments



Project INTERMODAL

- ❑ First public bicycle system in Dalmatia
- ❑ Delivery of goods by electric vehicles in old city centre



Project STEP-UP

- ❑ All available transport data standardized in GTFS format
- ❑ The development of E-Planner for the purpose of multimodal travel planning
- ❑ Realization of pilot project: Connecting Šibenik with two international airports with direct bus lines



The development of intermodal point

- ❑ Passenger port, freight port, bus terminal, public bicycle system and railway station within 500m distance



New city square „Poljana”

- ❑ Remodel of main city square „Poljana”
- ❑ Three storey underground garage
- ❑ 256 new parking spaces

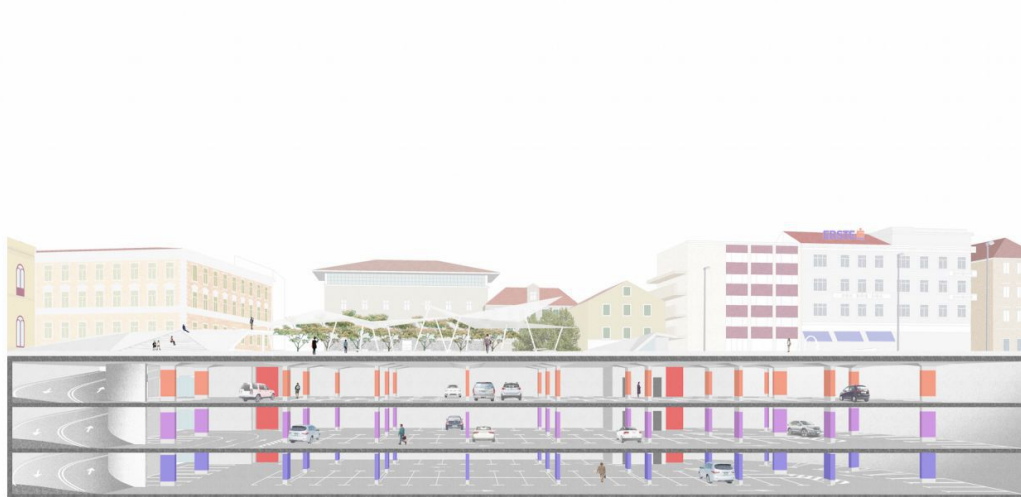

City of Šibenik new pilot project: Ship line in the bay



Thank you for your attention!

City of Šibenik
Petar Mišura

 Address: Petra Grubišića 1, 22000 Šibenik

 petar.misura@sibenik.hr

 +385 22 431 085

 www.italy-croatia.eu/step-up